

BINKS LOW PRESSURE DIAPHRAGM FLUID REGULATORS WITH ZINC BODY

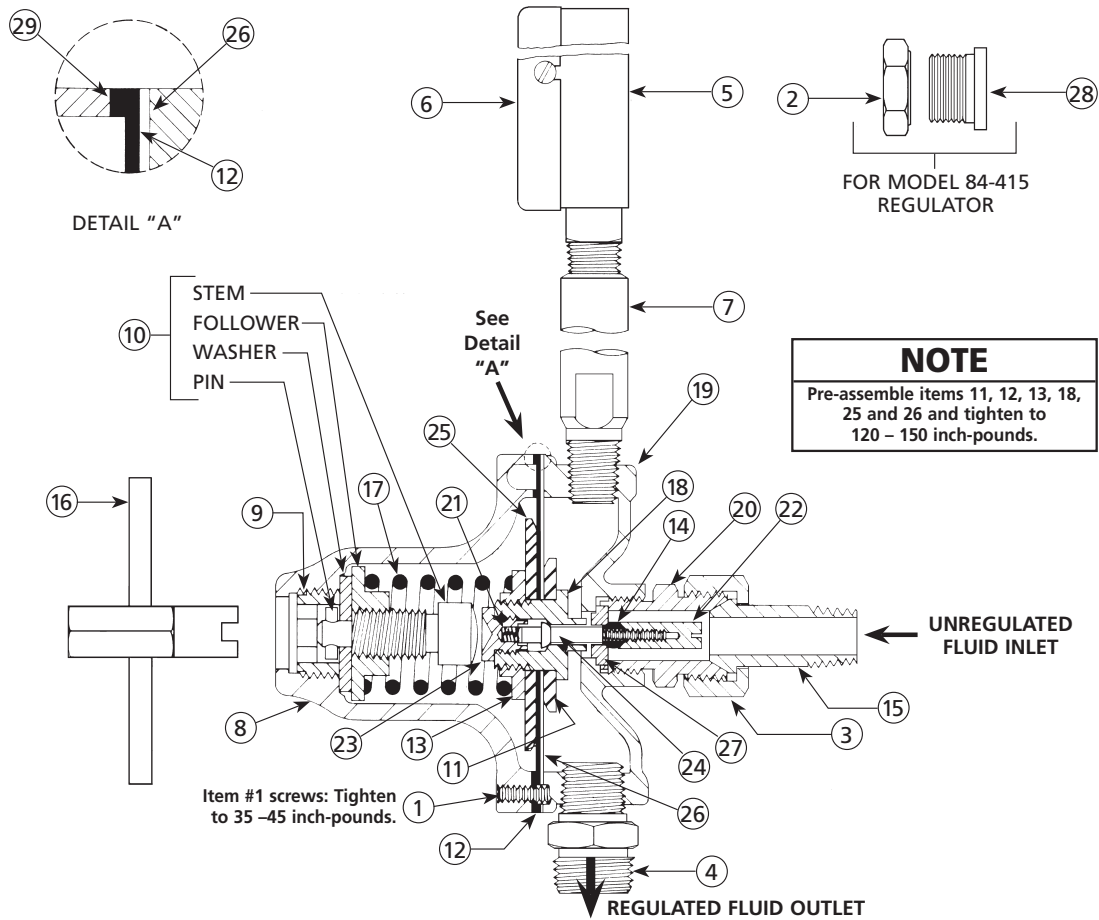

84-346 KEY OPERATED 84-415 REMOTE CONTROL (OBSOLETE)



PARTS LIST

When ordering, please specify Part No.

ITEM NO.	PART NO.	DESCRIPTION	QTY.	ITEM NO.	PART NO.	DESCRIPTION	QTY.
1	20-3699◆	SOC. HD. CAP SCREW 10-24 x 1".....	6	17	84-341*▲	SPRING.....	1
2	20-4456	LOCKNUT (84-415).....	1	18	84-342	RETAINER	1
3	72-337	SWIVEL NUT	1	19	84-344	BODY	1
4	73-50	D. M. NIPPLE	1	20	84-347	INLET	1
5	83-1636	GAUGE (0 - 15 PSI).....	1	21	84-353▲	SPRING.....	1
6	83-2052	GAUGE LENS (Replacement)	1	22	84-355	CAP	1
7	84-40	CONNECTOR	1	23	84-393	SOCKET.....	1
8	84-321	BONNET.....	1	24	84-395▲	ROD	1
9	84-322*	SCREW	1	25	84-398	DISC	1
10	84-325*	STEM ASSEMBLY	1	26	84-399▲■	DIAPHRAGM	1
11	84-328	DISC	1	27	84-450▲	SEAT	1
12	84-329▲■	DIAPHRAGM	1	28	84-460	BODY (84-415)	1
13	84-331	NUT.....	1	29	84-463▲■	GASKET	1
14	84-335▲	VALVE	1				
15	84-338	TAIL PIECE	1				
16	84-340*	KEY	1				

* Parts used only on Model 84-346 Regulator.
◆ Before installing regulator, tighten all 6 flange screws securely.
▲ Part of Repair Kit No. 84-591.
■ Part of Seal Kit Part No. 84-592.

In this part sheet, the words **WARNING**, **CAUTION** and **NOTE** are used to emphasize important safety information as follows:

⚠ WARNING
 Hazards or unsafe practices which could result in severe personal injury, death or substantial property damage.

⚠ CAUTION
 Hazards or unsafe practices which could result in minor personal injury, product or property damage.

NOTE
 Important installation, operation or maintenance information.

⚠ WARNING

Read the following warnings before using this equipment.



READ THE MANUAL
 Before operating finishing equipment, read and understand all safety, operation and maintenance information provided in the operation manual.



WEAR SAFETY GLASSES
 Failure to wear safety glasses with side shields could result in serious eye injury or blindness.



DE-ENERGIZE, DEPRESSURIZE, DISCONNECT AND LOCK OUT ALL POWER SOURCES DURING MAINTENANCE
 Failure to De-energize, disconnect and lock out all power supplies before performing equipment maintenance could cause serious injury or death.



OPERATOR TRAINING
 All personnel must be trained before operating finishing equipment.



EQUIPMENT MISUSE HAZARD
 Equipment misuse can cause the equipment to rupture, malfunction, or start unexpectedly and result in serious injury.



KEEP EQUIPMENT GUARDS IN PLACE
 Do not operate the equipment if the safety devices have been removed.



HIGH PRESSURE CONSIDERATION
 High pressure can cause serious injury. Relieve all pressure before servicing. Spray from the spray gun, hose leaks, or ruptured components can inject fluid into your body and cause extremely serious injury.



PRESSURE RELIEF PROCEDURE
 Always follow the pressure relief procedure in the equipment instruction manual.



ELECTRIC SHOCK/GROUNDING
 Improper grounding or sparks can cause a hazardous condition and result in fire, explosion or electric shock and other serious injury.

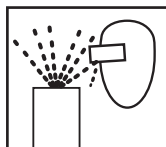

PROJECTILE HAZARD
 You may be injured by venting liquids or gases that are released under pressure, or flying debris.



INSPECT THE EQUIPMENT DAILY
 Inspect the equipment for worn or broken parts on a daily basis. Do not operate the equipment if you are uncertain about its condition.



NEVER MODIFY THE EQUIPMENT
 Do not modify the equipment unless the manufacturer provides written approval.



FIRE AND EXPLOSION HAZARD
 Improper equipment grounding, poor ventilation, open flame or sparks can cause hazardous conditions and result in fire or explosion and serious injury.



KNOW WHERE AND HOW TO SHUT OFF THE EQUIPMENT IN CASE OF AN EMERGENCY



STATIC CHARGE
 Fluid may develop a static charge that must be dissipated through proper grounding of the equipment, objects to be sprayed and all other electrically conductive objects in the dispensing area. Improper grounding or sparks can cause a hazardous condition and result in fire, explosion or electric shock and other serious injury.



PROP 65 WARNING
 WARNING: This product contains chemicals known to the State of California to cause cancer and birth defects or other reproductive harm.

IT IS THE RESPONSIBILITY OF THE EMPLOYER TO PROVIDE THIS INFORMATION TO THE OPERATOR OF THE EQUIPMENT.

FOR FURTHER SAFETY INFORMATION REGARDING BINKS AND DEVILBISS EQUIPMENT,
 SEE THE GENERAL EQUIPMENT SAFETY BOOKLET (77-5300).

INSTALLATION DATA

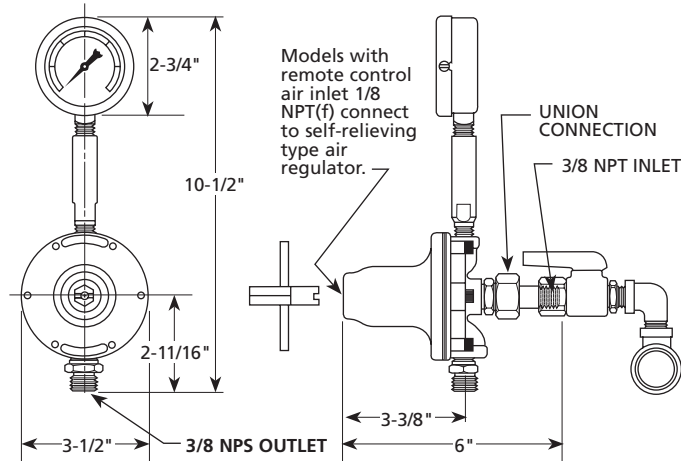

Installation is simplified by the use of a swivel nut inlet connection (see illustration). This is standard on all models; it eliminates the cost of a union, and provides a quick and convenient method to easily remove the unit from the line.

NOTE

Due to variations in diaphragm stretch, fluid flow may not shut-off when the pressure is backed off to zero. Install an inlet valve if complete shut-off is required.

Regulation Range	1 to 12 PSI	0.84 Kg/CM ²
Max. Rec. Flow	12 Oz./Min.	357 C.C./Min.
Max. Inlet Pressure	100 PSI	7 Kg/CM ²

OPERATING INSTRUCTIONS

MOUNTING: Regulator (3/8" NPT (m) Inlet) may be mounted in either a horizontal or vertical position. However, in *all* cases: to operate properly, gauge riser tube *must* be in a vertical position.

REGULATION: Use slotted end of key. Clockwise rotation increases pressure; counter-clockwise rotation reduces pressure.

NOTE

Fluid should be flowing through regulator when regulating pressure.

BLOW BACK: Use hexagon end of key. Turn counterclockwise

and gauge will read inlet pressure (main line pressure).

To shut off, turn key clockwise and gauge will return to normal regulated reading when flow begins.

CAUTION

When blowing back to reverse-flush regulator, be sure air pressure *does not* exceed maximum rating of gauge.

BZZING: When regulated pressure climbs, it normally indicates dirt on the seat; trigger gun rapidly to flush seat. If climbing continues, open regulator to main line to flush. If climbing still persists, replace valve and seat.

SERVICE INSTRUCTIONS

TO REPLACE FLUID VALVE AND SEAT:

Remove regulator from line by loosening the swivel nut; always blow back regulator before removing. At inlet, remove (counter-clockwise rotation) slotted cap nut with screwdriver; ball valve will slide off rod. Unscrew (counter-clockwise rotation) hexagon inlet retainer; valve seat will be removed with retainer.

Remove valve seat from retainer and replace if worn. Ball valve may be reversed and reused unless both sides are worn.

To reassemble: insert valve seat into retainer; note position of shoulder. Place ball valve on rod, and screw cap nut on rod and tighten. Screw hex retainer on to body and tighten. *Regulator requires no adjustments.*

TO REPLACE DIAPHRAGM: Remove regulator from line. At inlet, remove slotted cap nut with screwdriver; ball valve will slide off rod.

Remove bonnet by loosening (6) socket head cap screws. Clamp diaphragm assembly in vise, loosen nut (13) and remove diaphragm.

To reassemble: reverse above procedure.

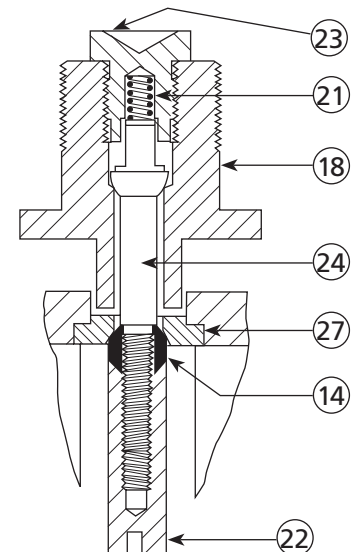

WARRANTY POLICY

Binks products are covered by Finishing Brands one year materials and workmanship limited warranty. The use of any parts or accessories, from a source other than Finishing Brands, will void all warranties. For specific warranty information please contact the closest Finishing Brands location listed below.

Finishing Brands reserves the right to modify equipment specifications without prior notice. DeVilbiss®, Ransburg®, BGK®, and Binks® are registered trademarks of Carlisle Fluid Technologies, Inc., dba Finishing Brands. ©2015 Carlisle Fluid Technologies, Inc., dba Finishing Brands. All rights reserved.



Binks is part of Finishing Brands, a global leader in innovative spray finishing technologies. For technical assistance or to locate an authorized distributor, contact one of our international sales and customer support locations below.

USA/Canada

www.binks.com
info@carlisleleft.com
Tel: 1-800-992-4657
Fax: 1-888-246-5732

Mexico

www.carlisleleft.com.mx
ventas@carlisleleft.com.mx
Tel: 011 52 55 5321 2300
Fax: 011 52 55 5310 4790

Brazil

www.devilbiss.com.br
vendas@carlisleleft.com.br
Tel: +55 11 5641 2776
Fax: 55 11 5641 1256

United Kingdom

www.finishingbrands.eu
info@carlisleleft.eu
Tel: +44 (0)1202 571 111
Fax: +44 (0)1202 573 488

France

www.finishingbrands.eu
info@carlisleleft.eu
Tel: +33(0)475 75 27 00
Fax: +33(0)475 75 27 59

Germany

www.finishingbrands.eu
info@carlisleleft.eu
Tel: +49 (0) 6074 403 1
Fax: +49 (0) 6074 403 281

China

www.finishingbrands.com.cn
mkt@carlisleleft.com.cn
Tel: +8621-3373 0108
Fax: +8621-3373 0308

Japan

www.ransburg.co.jp
overseas-sales@carlisleleft.co.jp
Tel: 081 45 785 6421
Fax: 081 45 785 6517

Australia

www.finishingbrands.com.au
sales@carlisleleft.com.au
Tel: +61 (0) 2 8525 7555
Fax: +61 (0) 2 8525 7500

