

**Soft brass
insert will
not damage
gun.**

DeKUPS® 803237/DPC-501 ADAPTER FOR SATA® QCC FULL SIZE INSTALLATION INSTRUCTIONS

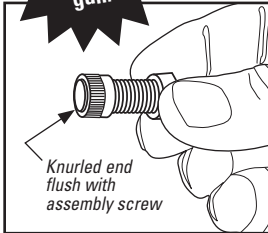

1. Install insert on screw until knurled groove end is flush.

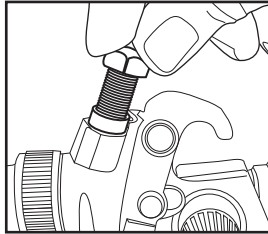

2. Place Insert with screw into gun.

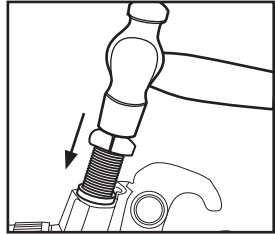

3. Lightly tap into gun until insert hits bottom of gun hole. The soft brass insert will not damage gun.

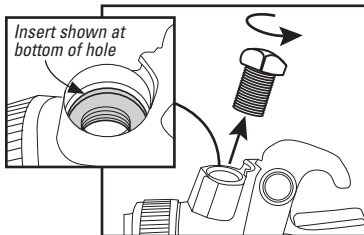

4. Remove screw.

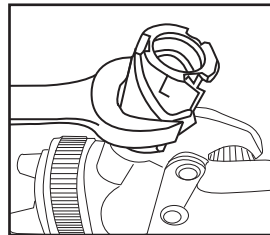

5. Tighten adapter tightly to expand insert and seal fluid path.

ADAPTER INSERT REMOVAL INSTRUCTIONS

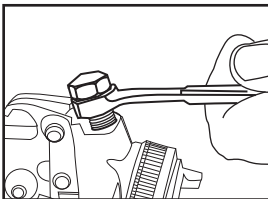

1. Place screw* thru box end wrench. Install screw partially into gun's adapter insert.

*7/16-20x1½ long

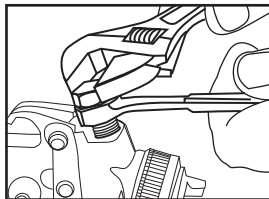

2. Use second wrench to tighten screw against first wrench. This method will pull insert out of the gun.

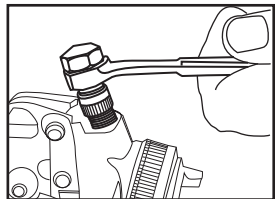

3. Remove insert with screw. The gun will not be damaged.